



ASPIRE

— TO MOVE —



Downleaze, Stoke Bishop, Bristol, BS9

Video viewing and physical viewings available on this property. One bedroom, lower ground floor flat that is offered furnished. Located just off Clifton Downs the flat is available from the 11th September. Best suited for a single professional or a professional couple. Students accepted.

Stoke Bishop is an area North West of Bristol city centre and just 0.1 miles from Clifton Downs. There is a bus stop with access into Bristol 0.1 miles away. Whiteladies road and Clifton is located just 0.5 miles away.

£1,300 PCM

Downleaze, Stoke Bishop, Bristol, BS9

- Lower ground floor flat
- Desirable location
- 1 Bedroom
- Patio area
- Furnished
- Newly refurbished
- Available immediately
- Council Tax Band F
- Holding deposit - £300

Video viewing and physical viewings available on this property. One bedroom, lower ground floor flat that is offered furnished. Located just off Clifton Downs the flat is available from the 11th September. Best suited for a single professional or a professional couple. Students accepted.

Stoke Bishop is an area North West of Bristol city centre and just 0.1 miles from Clifton Downs. There is a bus stop with access into Bristol 0.1 miles away. Whiteladies road and Clifton is located just 0.5 miles away.

The property is located on the lower ground floor and is offered furnished. The bedroom is large and comes with a double bed, bedside table and desk with chair. There is an integrated wardrobe. The kitchen has base and wall units, fridge, freezer, washing machine and a cooker with hob and extractor. The living is equipped with a sofa, dining table, chairs and coffee table. There is a small patio / terrace to the front of the property.

The property would be best suited for a single professional or a professional couple. Students accepted. Available furnished on a 12 month tenancy from the 11th September.

Council Tax Band - F - £3,732.28 per year

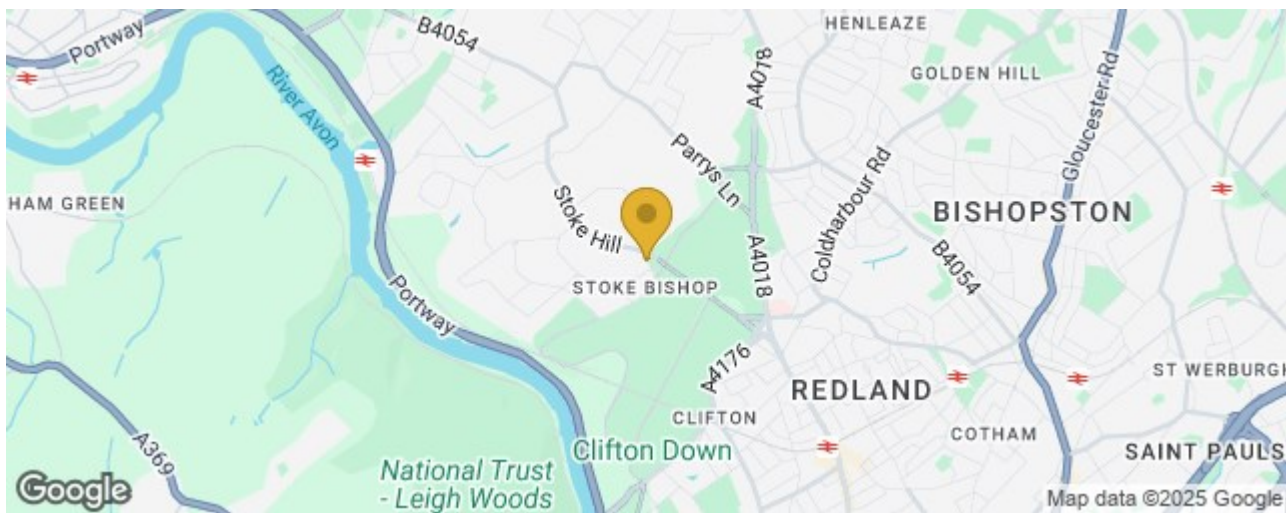



Floor Plan

GROUND FLOOR
621 sq.ft. (57.7 sq.m.) approx.

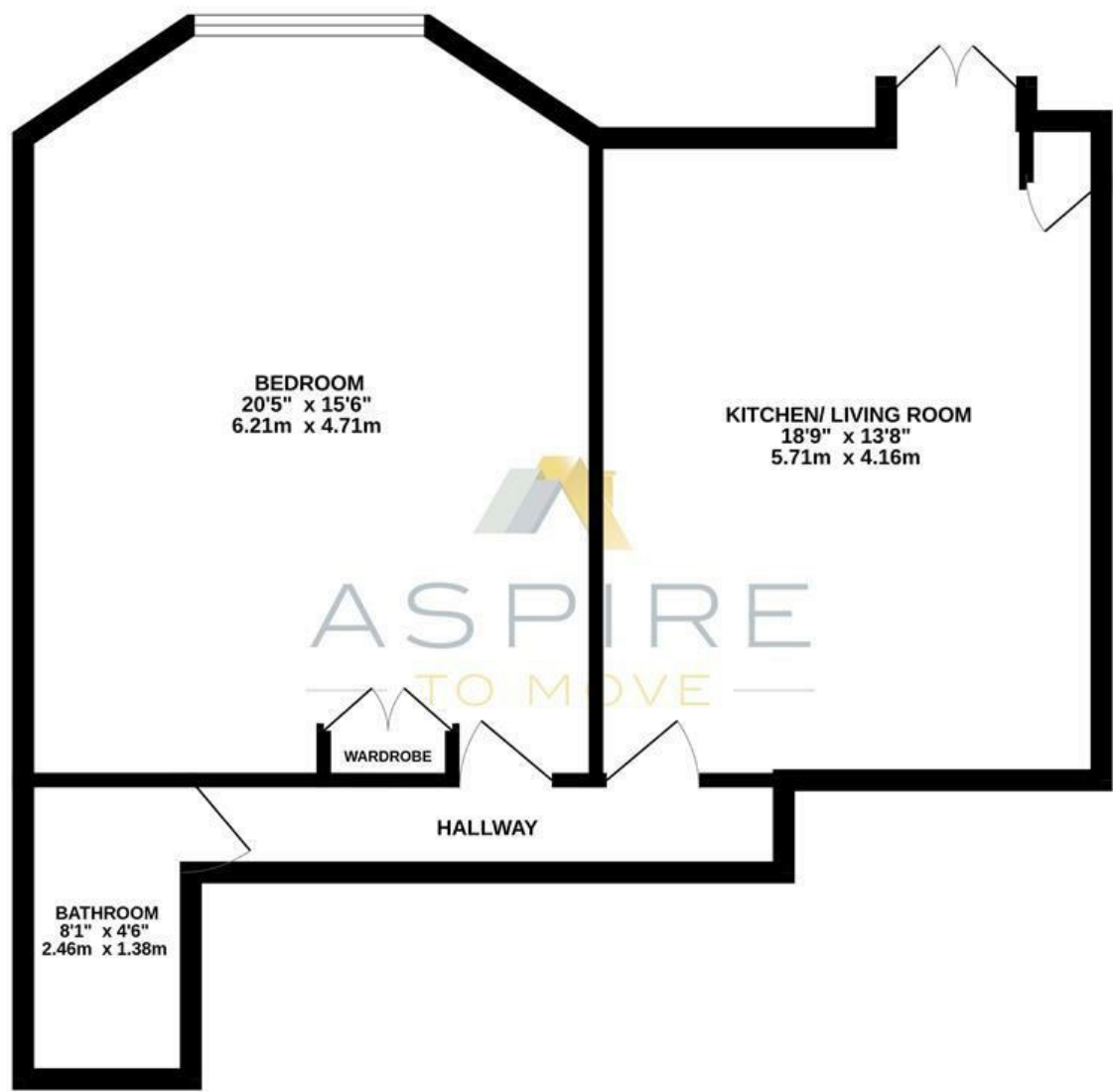

TOTAL FLOOR AREA : 621 sq.ft. (57.7 sq.m.) approx.
Whilst every attempt has been made to ensure the accuracy of the floorplan contained here, measurements of doors, windows, rooms and any other items are approximate and no responsibility is taken for any error, omission or mis-statement. This plan is for illustrative purposes only and should be used as such by any prospective purchaser. The services, systems and appliances shown have not been tested and no guarantee as to their operability or efficiency can be given.
Made with Metropix ©2024

These particulars, whilst believed to be accurate are set out as a general outline only for guidance and do not constitute any part of an offer or contract. Intending purchasers should not rely on them as statements of representation of fact, but must satisfy themselves by inspection or otherwise as to their accuracy. No person in this firms employment has the authority to make or give any representation or warranty in respect of the property.

